

Date received: 29/4/21
Deposit No: 7121



Form CA16

Application Form for Deposits under Section 31(6) of the Highways Act 1980 and Section 15A(1) of the Commons Act 2006

Please read the following guidance carefully before completing this form

1. Guidance relating to completion of this form is available from <http://www.defra.gov.uk/rural/protected/greens/> . Please refer to these separate notes when completing this form.
2. Parts A and F must be completed in all cases.
3. The form must be signed and dated by, or by a duly authorised representative of, every owner of land to which the application relates who is an individual, and by the secretary or some other duly authorised officer of every owner of land to which the application relates which is a body corporate or an unincorporated association.
4. In the case of land in joint ownership all the joint owners must complete paragraphs 2 and 3 of Part A and complete and sign the application in Part F, unless a duly authorised representative completes and signs the form on behalf of all of the owners of the land. Paragraph 3 should be completed in full to clearly explain the capacity of each applicant e.g. trustee, landowner's managing agent, executor.
5. 'Owner' is defined in section 61(3) of the Commons Act 2006 and section 31(7) of the Highways Act 1980 and means, broadly, a legal owner of the freehold interest in the land.
6. Where the application relates to more than one parcel of land, a description of each parcel should be included in Paragraph 4 of Part A and the remainder of the form should be completed to clearly identify which statement and/or declaration relates to which parcel of land. This may require the insertion of additional wording. See separate notes for further guidance. Multiple parcels of land should be clearly identified by coloured edging on any accompanying map.
7. Where a statement or declaration requires reference to colouring shown on an accompanying map or previously lodged map, the colouring must be clearly specified and must match that shown on the relevant map. For example, if a footpath is specified in a Part C declaration as shown coloured brown, the accompanying map or previously deposited map referred to must reflect that colouring.
8. An application must be accompanied by an ordnance map, or (in respect of declarations under Part C or statements under Part D of this form) refer

to a map previously deposited in accordance with the Commons (Registration of Town or Village Greens) and Dedicated Highways (Landowner Statements and Declaration) (England) Regulations 2013 or (if deposited before 1st October 2013) in accordance with section 31(6) of the Highways Act 1980. Any accompanying map must be an Ordnance map at a scale of not less than 1:10,560 showing the boundary of the land to which the application relates in coloured edging.

9. An application must be accompanied by the requisite fee – please ask the appropriate authority for details.
10. 'Appropriate authority' means (a) in relation to a map or statement deposited or declaration lodged under section 31(6) of that Act, an appropriate council (as defined in section 31(7) of the Highways Act 1980); and (b) in relation to a statement and map deposited under section 15A(1) of the 2006 Act, a commons registration authority (defined in section 4 of the Commons Act 2006 and section 2 of the Commons Registration Act 1965). In practice, the appropriate council and commons registration authority will usually be the same body.

Please send your completed application form and map, together with a cheque for **£402** made payable to 'West Sussex County Council' to:

Rights of Way, Legal Services
West Sussex County Council
County Hall, West Street
Chichester
West Sussex
PO19 1RQ

PART A

Information relating to the applicant and land to which the application relates

(All applicants must complete this Part)

1. Name of appropriate authority to which the application is addressed: West Sussex County Council
2. Name and full address (including postcode) of applicant: Andrew Atkinson of Strutt & Parker, 55 Northbrook Street, Newbury, Berkshire RG14 1AN
3. Status of applicant (tick relevant box or boxes): I am (a) <input type="checkbox"/> the owner of the land(s) described in paragraph 4. (b) <input checked="" type="checkbox"/> making this application and the statements/declarations it contains on behalf of David Charles Heaver and Eurequity IC Ltd who are the joint owners of the land(s) described in paragraph 4 and in my capacity as their agent
4. Insert description of the land(s) to which the application relates (including full address and postcode) Land at Old Place Farm, Old Place Lane, Westhampnett, Chichester, PO18 0NL, edged red on the plan labelled "Land at Old Place Farm". Land south of Shopwyke Road, Chichester, PO20 2AA, edged red on the plan labelled "Land south of Shopwyke Road, Chichester" Land at East Ashling, Chichester, PO18 9AU, edged red on the plan labelled "Land at East Ashling"
5. Ordnance survey six-figure grid reference(s) of a point within the area of the land(s) to which the application relates (if known) Land at Old Place Farm : SU872066 Land south of Shopwyke Road, Chichester : SU885047 Land at East Ashling : SU816077
6. This deposit comprises the following statement(s) and/or declarations Statement under section 31(6) of the Highways Act 1980 Statement under section 15A(1) of the Commons Act 2006

PART B

Statement under Section 31(6) of the Highways Act 1980

David Charles Heaver and Eurequity IC Ltd are the joint owners of the land described in paragraph 4 of Part A of this form and shown edged red on the three maps accompanying this statement.

Ways shown coloured **purple** on the accompanying maps are public footpaths.

Map of Old Place Farm, Westhampnett – footpath 3044

Map of Land south of Shopwyke Road, Chichester – no highways

Map of land at East Ashling – footpaths 265 & 268

No other ways over the land shown edged red on the accompanying maps have been dedicated as highways.

PART C

Declaration under Section 31(6) of the Highways Act 1980

Deleted

PART D

Statement under Section 15A of the Commons Act 2006

David Charles Heaver and Eurequity IC Ltd are the joint owners of the land described in paragraph 4 of Part A of this form and shown edged red on the three maps accompanying this statement.

David Charles Heaver and Eurequity IC Ltd wish to bring to an end any period during which persons may have indulged as of right in lawful sports and pastimes on the whole or any part of the land shown edged red on the three maps accompanying this statement

PART E

Additional information relevant to the application
(insert any additional information relevant to the application)

PART F

Statement of Truth
(all applicants **must** complete this part)

WARNING: If you dishonestly enter information or make a statement that you know is, or might be, untrue or misleading, and intend by doing so to make a gain for yourself or another person, or to cause loss or the risk of loss to another person, you may commit the offence of fraud under section 1 of the Fraud Act 2006, the maximum penalty for which is 10 years' imprisonment or an unlimited fine, or both.

I BELIEVE THAT THE FACTS AND MATTERS CONTAINED IN THIS FORM ARE TRUE

Signature (of the person making the statement/of truth):

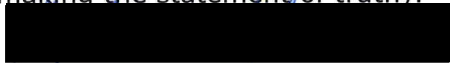

Print full name: **ANDREW ATKINSON**

Date: 28/4/2021

You should keep a copy of the completed form

DATA PROTECTION ACT 1998 – FAIR PROCESSING NOTICE

The purpose of this Fair Processing Notice is to inform you of the use that will be made of your personal data, as required by the Data Protection Act 1998.

The appropriate authority (see explanation of definition in above guidance notes) in England is the data controller in respect of any personal data that you provide when you complete this form.

The information that you provide will be used by the appropriate authority in its duties to process applications to deposit statements, maps and declarations under section 31(6) the Highways Act 1980 and statements under section 15A(1) of the Commons Act 2006. The information you provide will also be used by the appropriate authority in its duty to update the registers in which details of such deposits are recorded under the Dedicated Highways (Registers under Section 31A of the Highways Act 1980) (England) Regulations 2007 and the Commons (Registration of Town or Village Greens) and Dedicated Highways (Landowner Statements and Declarations) (England) Regulations 2013.

The appropriate authority is required by the legislation above to maintain a register which holds information provided in this form, which can be inspected online or in person by members of the public on request. It may also be required to release information, including personal data and commercial information, on request under the Environmental Information Regulations 2004 or the Freedom of Information Act 2000. However, the appropriate authority will not permit any unwarranted breach of confidentiality nor will they act in contravention of their obligations under the Data Protection Act 1998

3044

Fordwater Cottages

River Lavant

STOCKS LANE (Track)

Air Ambulance Station

Chichester (Goodwood) Airfield

Goodwood Motor Circuit

Grain Drier

CLAYPT LANE

THE DRIVE

SU872066

SU879067

Old Place Farm

The March Church of England Primary School

SU872062

MADGWICK LANE

Maudlin Nursery

SU875061

Westhampton Mill

D C Heaver & Eurequity IC Ltd

Land at Old Place Farm

SCALE : 1 : 8000 @ A4

DATE : 03/04/2021



MAP FILENAME : row op 2021

Map data shown may contain Ordnance Survey © products supplied by Pear Technology Services Ltd; Email: info@peartechology.co.uk © Crown Copyright and database rights from date shown above Ordnance Survey © licence number 100023148

0 500m

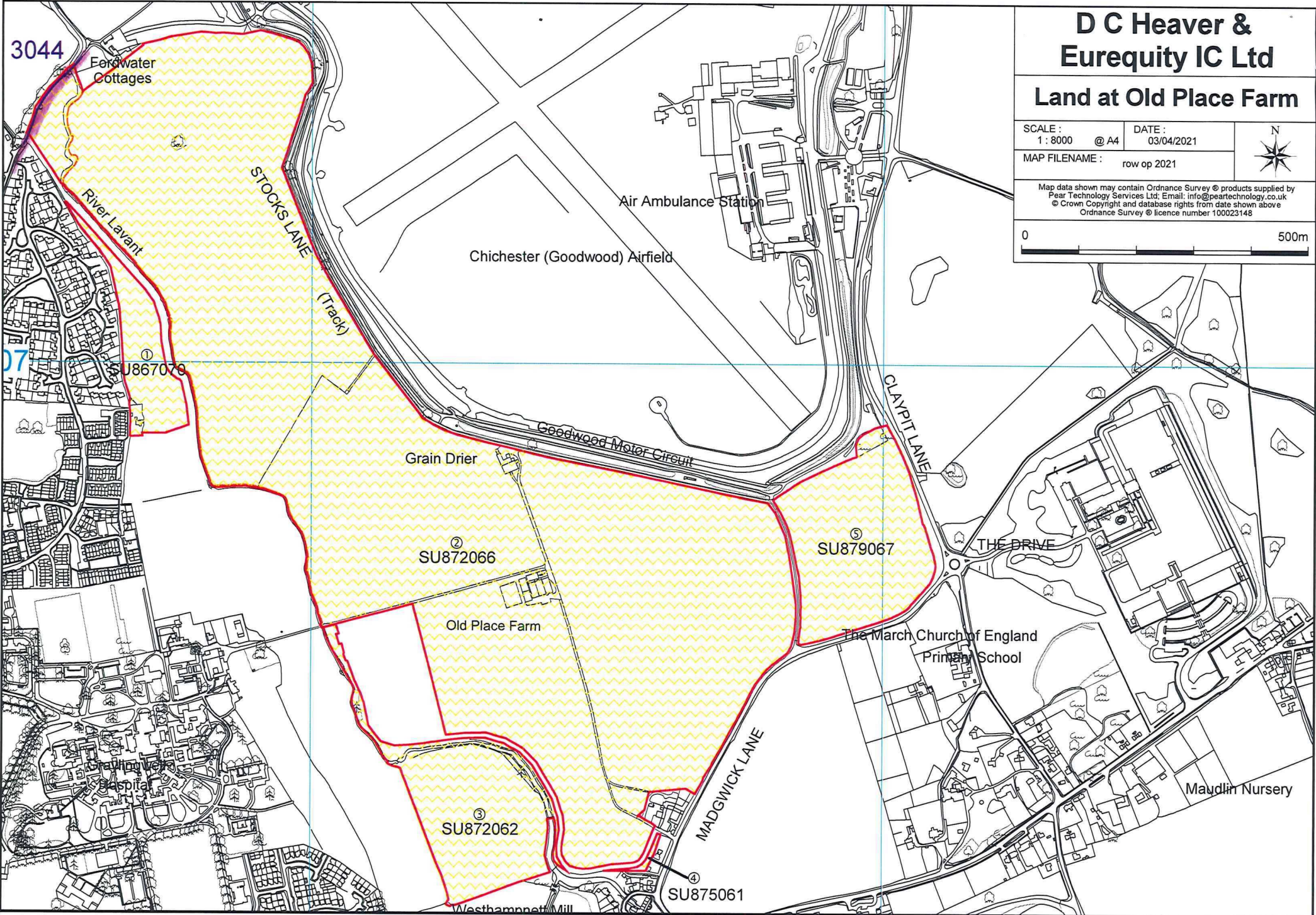

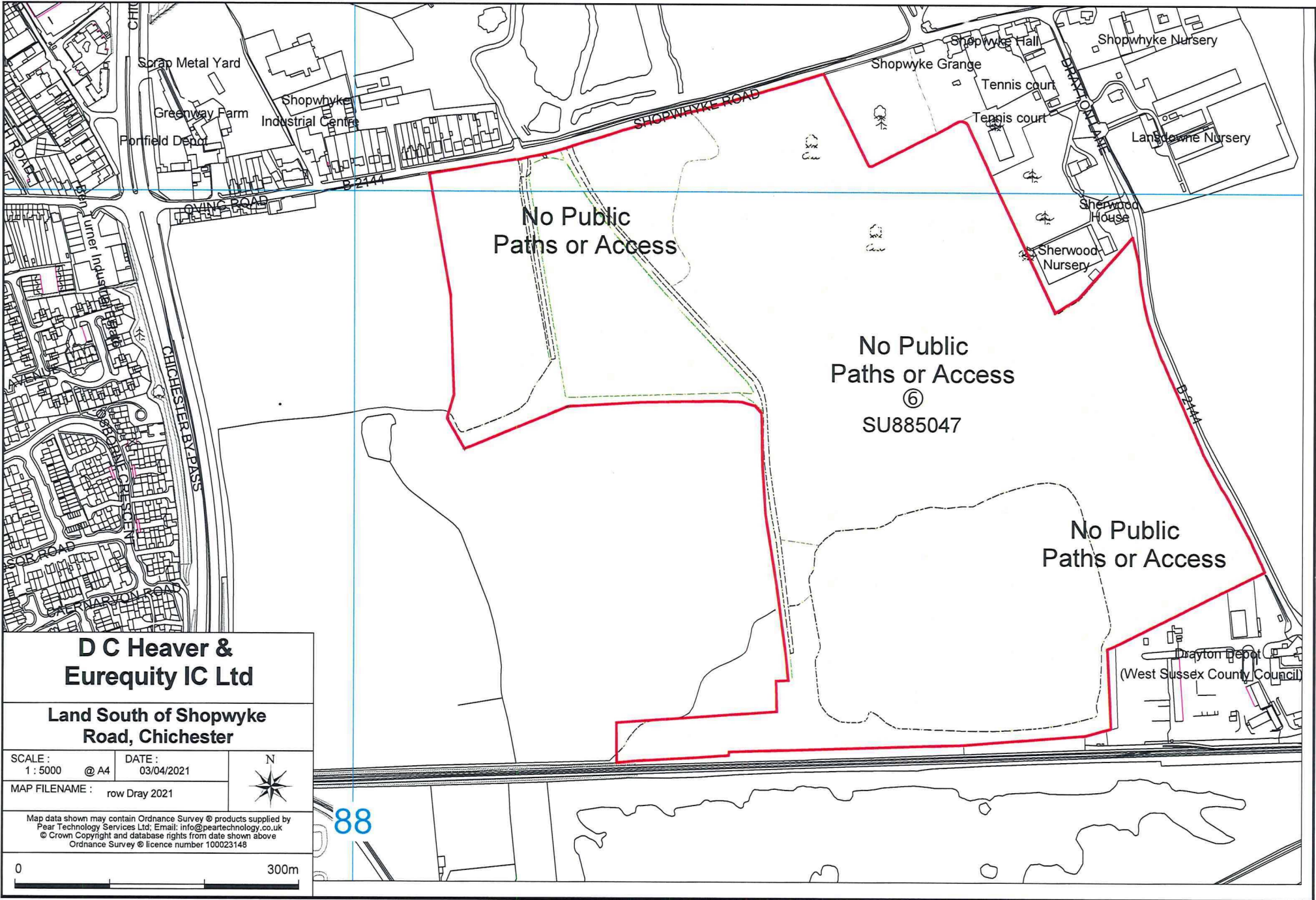

D C Heaver & Eurequity IC Ltd

Land South of Shopwyke Road, Chichester

SCALE : 1 : 5000 @ A4	DATE : 03/04/2021
MAP FILENAME : row Dray 2021	

Map data shown may contain Ordnance Survey © products supplied by Pear Technology Services Ltd; Email: info@peartechnology.co.uk
© Crown Copyright and database rights from date shown above
Ordnance Survey © licence number 100023148

0 300m

88

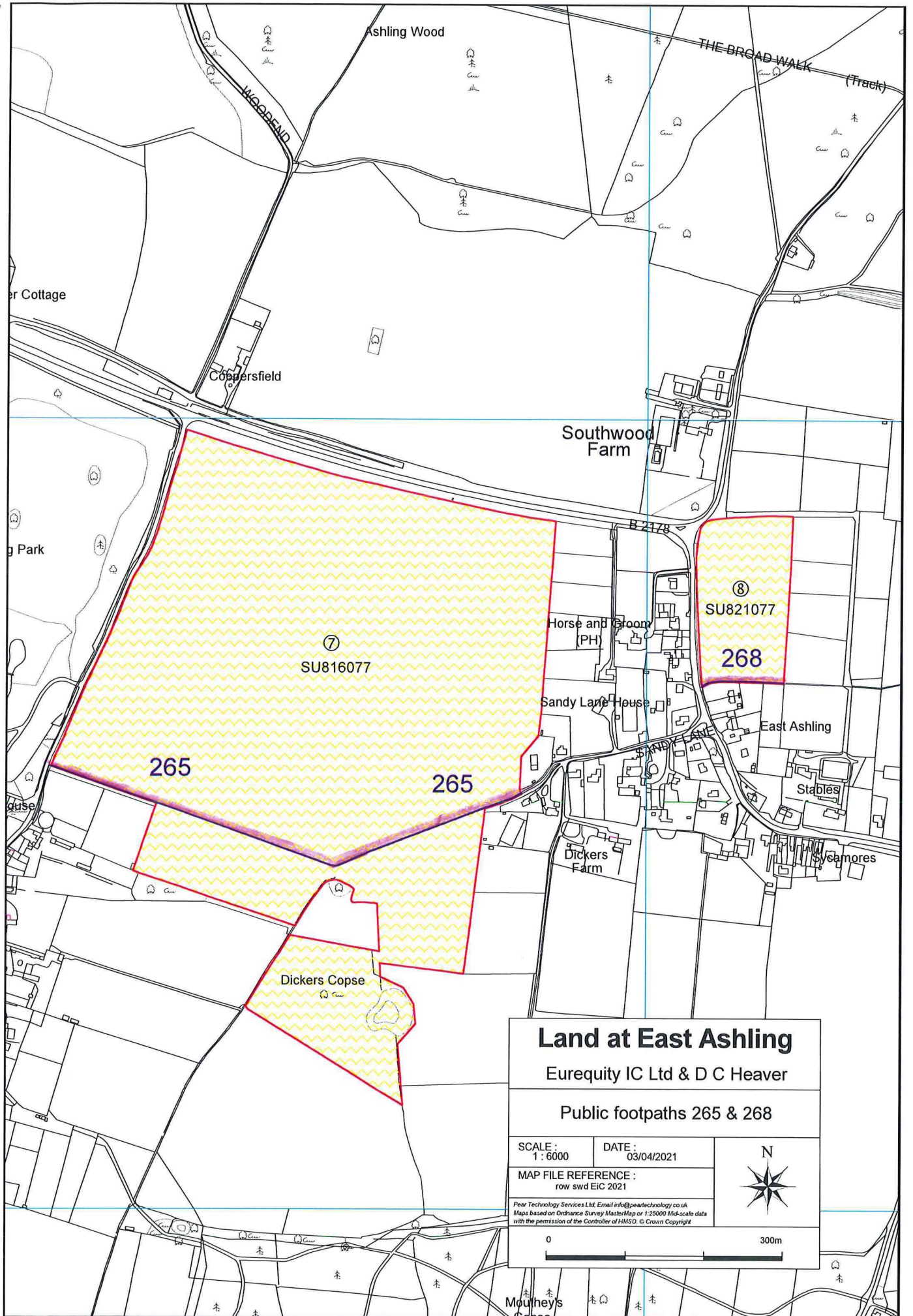

Land at East Ashling

Eurequity IC Ltd & D C Heaver

Public footpaths 265 & 268

SCALE :
1 : 6000

DATE :
03/04/2021

MAP FILE REFERENCE :
row swd EIC 2021



Pear Technology Services Ltd. Email info@peartechnology.co.uk
Maps based on Ordnance Survey MasterMap or 1:25000 Mid-scale data
with the permission of the Controller of HMSO. © Crown Copyright

