

# PART A

**Information relating to the applicant and land to which the application relates**  
**(All applicants must complete this Part)**

1. Name of appropriate authority to which the application is addressed: <b>West Sussex County Council</b>
2. Name and full address (including postcode) of applicant: <b>ANTONIA COSBY of Forsters LLP, 31 Hill Street, London W1J 5LS</b>
3. Status of applicant (tick relevant box or boxes):  I am  (a) <input type="checkbox"/> the owner of the land(s) described in paragraph 4.  (b) <input checked="" type="checkbox"/> making this application and the statements/declarations it contains on behalf of <b>JOHN HENRY EDMUND WELLS</b> and <b>SUSAN JANE WELLS</b> who are the owners of the lands described in paragraph 4 and in my capacity as their solicitor.
4. Insert description of the land(s) to which the application relates (including full address and postcode)  <b>Land at Fletchers Barn, Old Park Lane, Bosham, Chichester PO18 8EY shown edged red on Plan 1 (attached) and land at Old Park Farm, Old Park Lane, Bosham, Chichester PO18 8EX, registered at the Land Registry with title number WSX286714 and shown edged red on Plan 2 (attached), (together "the Property").</b>
5. Ordnance survey six-figure grid reference(s) of a point within the area of the land(s) to which the application relates (if known)  <b>Not known</b>
6. This deposit comprises the following statement(s) and/or declarations (delete parts B, C or D where not applicable):

## PART B

### Statement under Section 31(6) of the Highways Act 1980

**JOHN HENRY EDMUND WELLS** and **SUSAN JANE WELLS** are the owners of the Property.

Ways shown highlighted orange and labelled "236" and "237" on the accompanying Plan 3 are public footpaths.

No other ways over the Property have been dedicated as highways.

## PART F

### Statement of Truth

*(all applicants **must** complete this part)*

WARNING: If you dishonestly enter information or make a statement that you know is, or might be, untrue or misleading, and intend by doing so to make a gain for yourself or another person, or to cause loss or the risk of loss to another person, you may commit the offence of fraud under section 1 of the Fraud Act 2006, the maximum penalty for which is 10 years' imprisonment or an unlimited fine, or both.

**I BELIEVE THAT THE FACTS AND MATTERS CONTAINED IN THIS FORM ARE TRUE**

Signature (of the person making the statement of truth):

Print full name:

ANTONIA COSBY

Date:

12 October 2015

**You should keep a copy of the completed form**

### DATA PROTECTION ACT 1998 – FAIR PROCESSING NOTICE

The purpose of this Fair Processing Notice is to inform you of the use that will be made of your personal data, as required by the Data Protection Act 1998.

The appropriate authority (see explanation of definition in above guidance notes) in England is the data controller in respect of any personal data that you provide when you complete this form.

The information that you provide will be used by the appropriate authority in its duties to process applications to deposit statements, maps and declarations under section 31(6) the Highways Act 1980 and statements under section 15A(1) of the Commons Act 2006. The information you provide will also be used by the appropriate authority in its duty to

update the registers in which details of such deposits are recorded under the Dedicated Highways (Registers under Section 31A of the Highways Act 1980) (England) Regulations 2007 and the Commons (Registration of Town or Village Greens) and Dedicated Highways (Landowner Statements and Declarations) (England) Regulations 2013.

The appropriate authority is required by the legislation above to maintain a register which holds information provided in this form, which can be inspected online or in person by members of the public on request. It may also be required to release information, including personal data and commercial information, on request under the Environmental Information Regulations 2004 or the Freedom of Information Act 2000. However, the appropriate authority will not permit any unwarranted breach of confidentiality nor will they act in contravention of their obligations under the Data Protection Act 1998

PLAN 1

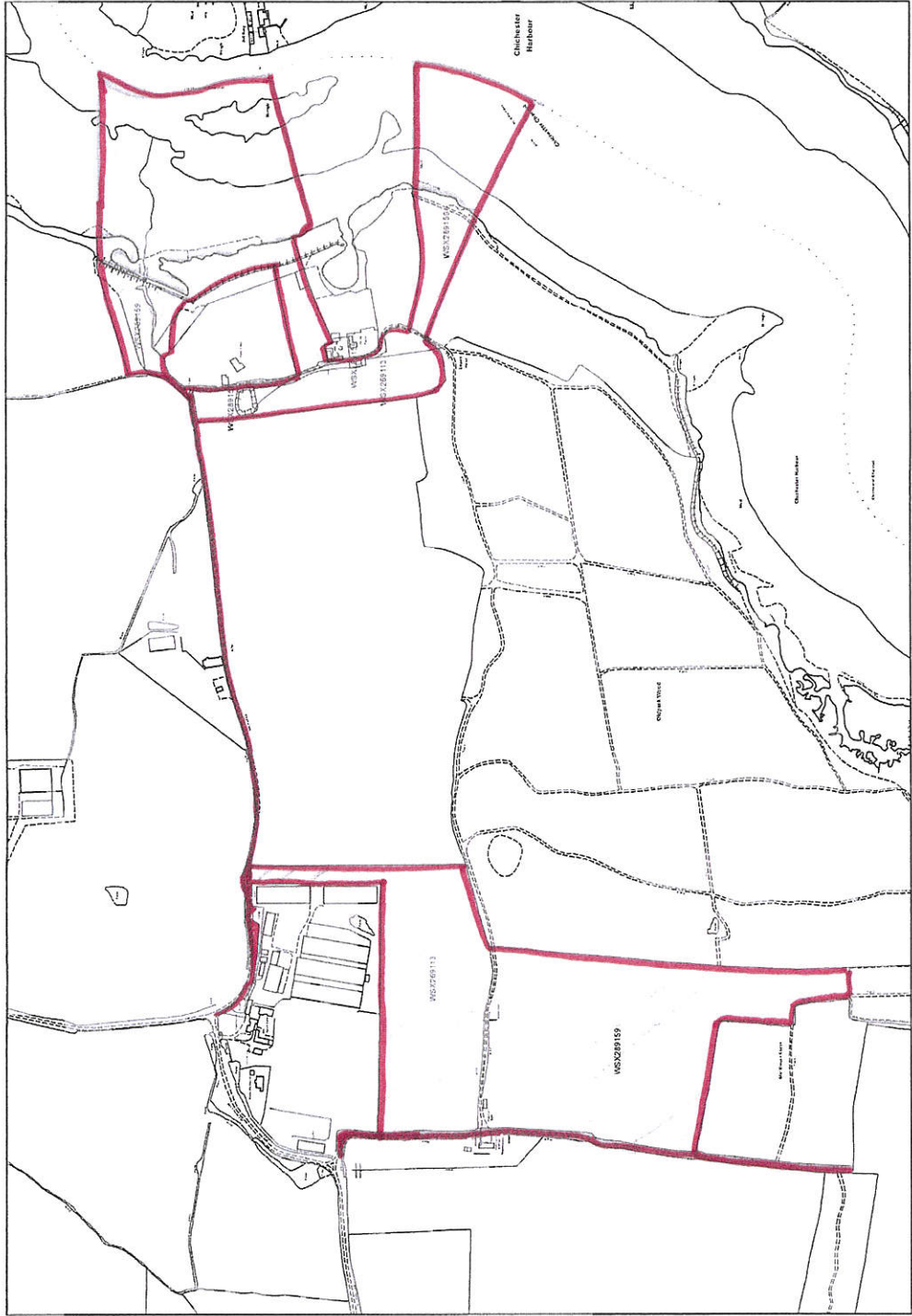



Pln 2

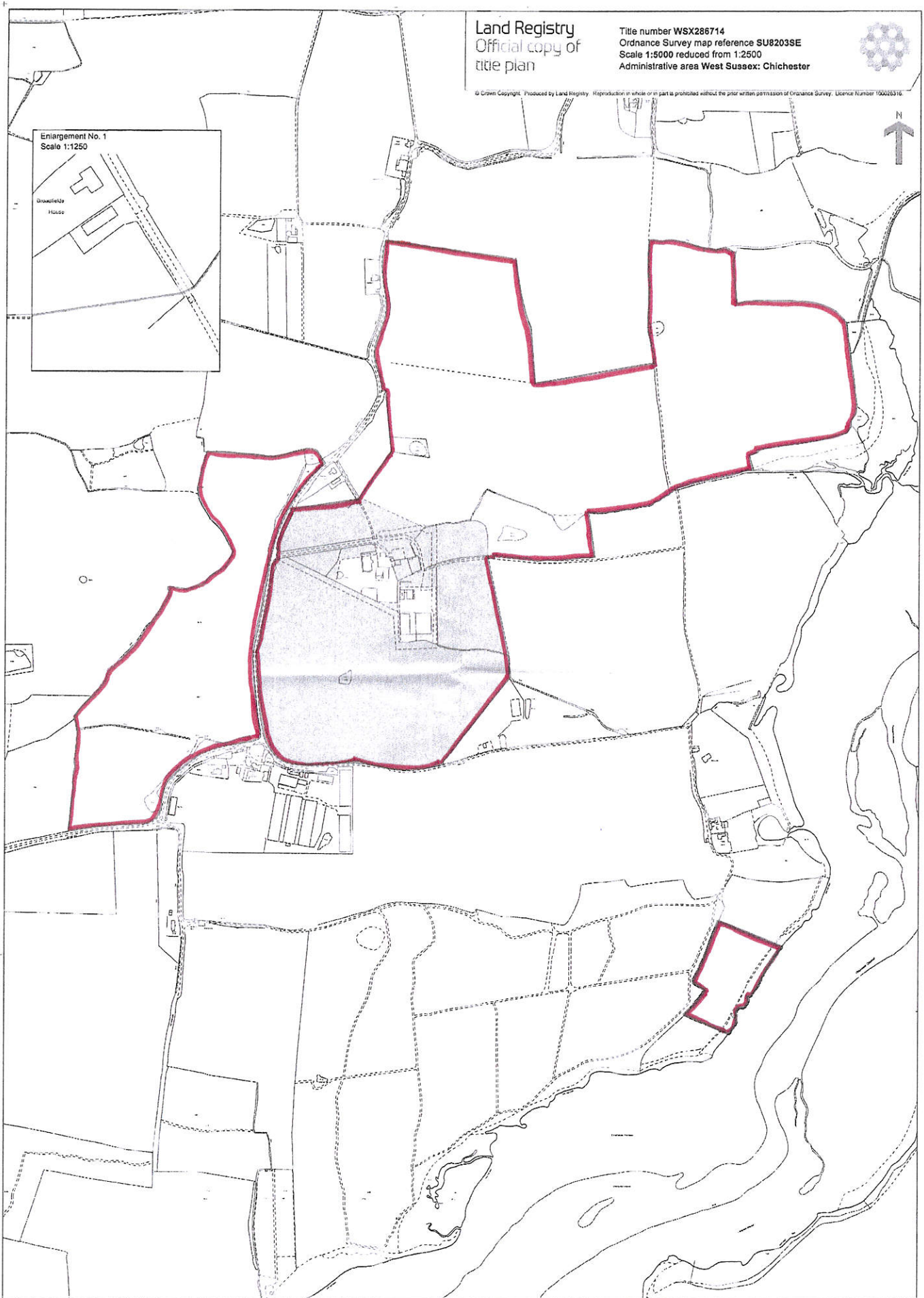

Land Registry  
Official copy of  
title plan

Title number WSX286714  
Ordnance Survey map reference SU8203SE  
Scale 1:5000 reduced from 1:2500  
Administrative area West Sussex: Chichester



© Crown Copyright. Produced by Land Registry. Reproduction in whole or in part is prohibited without the prior written permission of Ordnance Survey. Licence Number 100025316.

This official copy issued on 22 September 2015 shows the state of this title plan on 21 September 2015 at 14:26:30. It is admissible in evidence to the same extent as the original (s.67 Land Registration Act 2002).  
This title plan shows the general position, not the exact line, of the boundaries. It may be subject to distortions in scale. Measurements scaled from this plan may not match measurements between the same points on the ground.  
This title is dealt with by Land Registry, Coventry Office.





Search

Search

237 Search

237, FOOTPATH

Drag the pin onto the map to set your location



Map features  
Overlay additional geographical features in your local area.

- ☒ West Sussex County
  - ☒ West Sussex Parish
  - ☒ Tourist Information Centres
  - ☐ Town Trails
  - ☒ Paths
  - ☐ Footpath
  - ☐ Bridleway
  - ☐ Restricted Byway
  - ☐ Byway open to all traffic
  - ☐ Permissive Paths
  - ☐ Walks
  - ☐ Easy Access Trails
  - ☐ Southdowns National Park
- Hide all

